

PUMP

INDUSTRY SOLUTIONS

ROADMAP

Solutions For Every Application

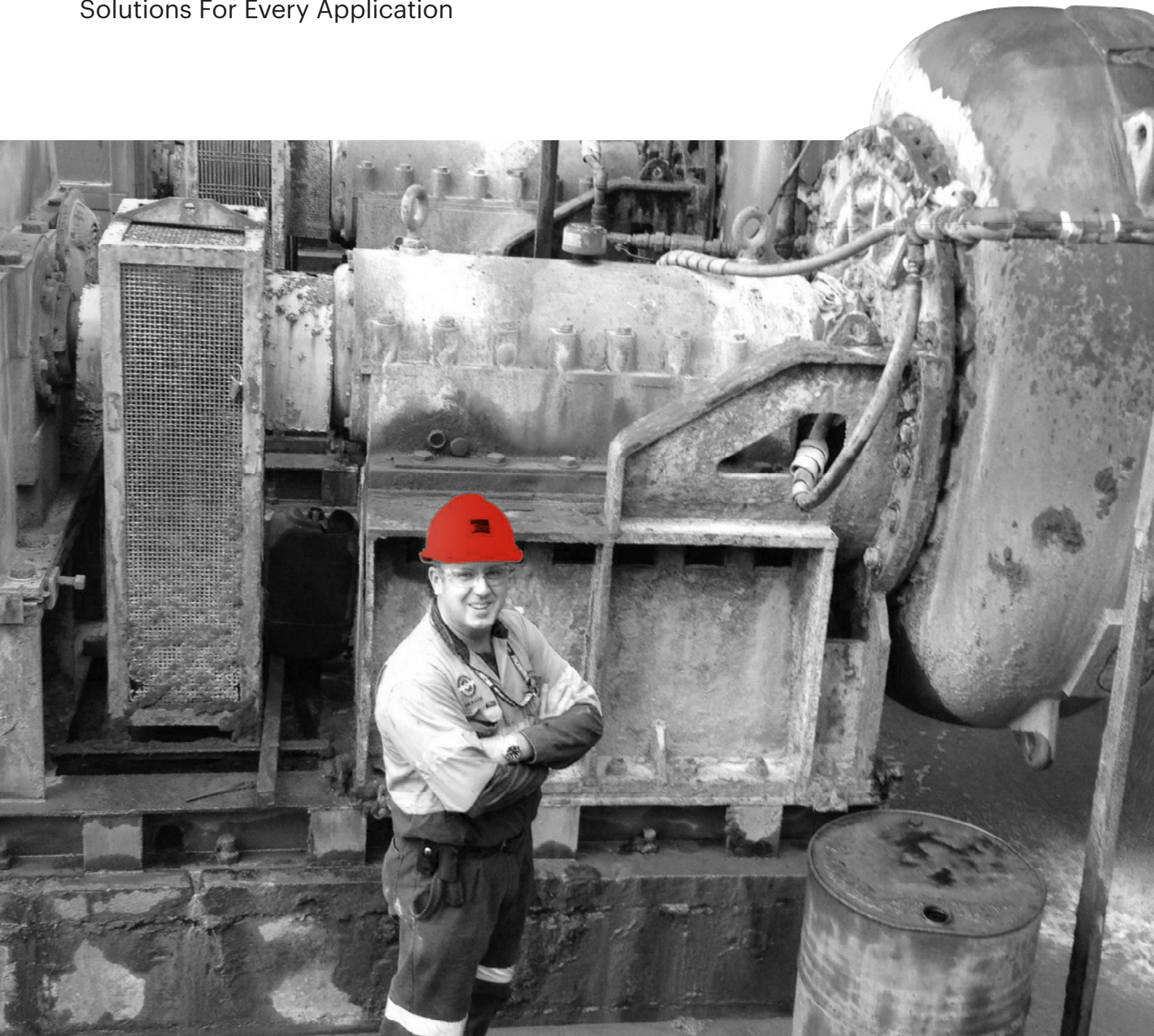

MOTION[®]
Australia

PUMP ROADMAP



ELECTRIC MOTOR



MOTORBASES AND TENSIONERS



ORANGE PEEL®

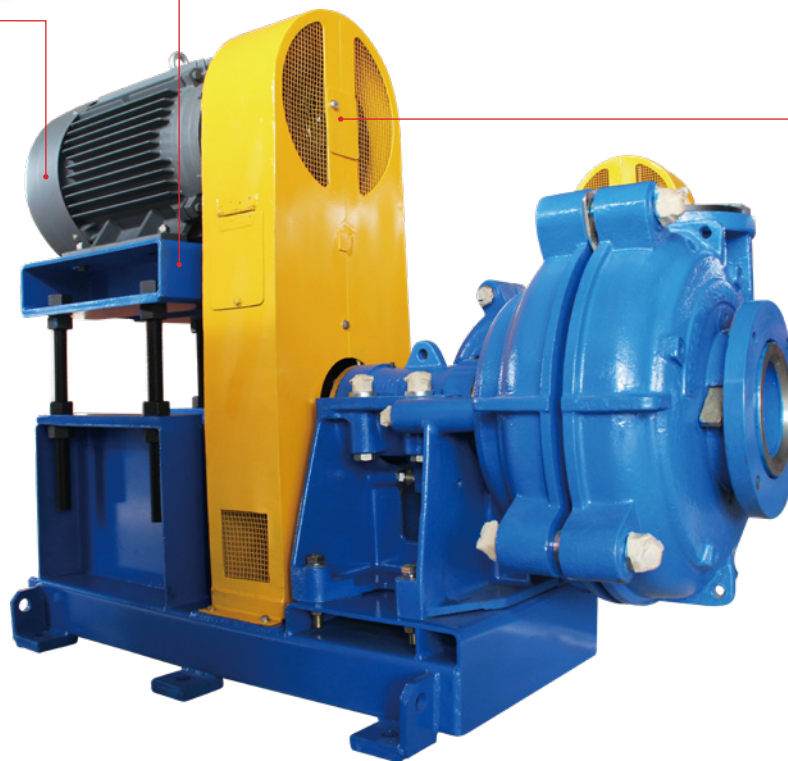

Products

- Alignment Shims – **SiL**
- Bearing Isolator – **SiL**
- Bearings – **NTN, NSK, TIMKEN**
- Belt Guards – **SPECFAST**
- Blacksteel Pipe Fittings – **POWAFIT**
- Buttweld Fittings – **POWAFIT**
- Corrosion Protection Tape – **3M**
- Couplings – **TIMKEN, FENNER, REXNORD**
- Cover Plate – **SiL**
- Extractor and Tamping Tools – **SiL**
- Galvanised Steel Backing Rings – **POWAFIT**
- Gland Packing – **SiL**
- Knife Gate Valves – **POWAFLO**
- Lantern Ring
- Lubrication – PERMA, MOLYKOTE, **ALEMLUBE**
- Mechanical Seals – **SiL**
- Motor – **TECO, WEG**
- Motor Mount Tensioners – ROSTA, LEVERLINK
- O-Ring – **SiL**
- Packings – **SiL**
- Powaflex Rubber Expansion Joints – **POWAFIT**
- Pulleys – **FENNER**
- Rotary Seal – **SiL**
- Seals – **SiL**
- Shaft Sleeve – **SiL**
- Taperlocks – **FENNER**
- V-Belts – **GATES, FENNER, TIMKEN**
- Wafer Check Valves – **POWAFLO**
- Water and Material Handling Hose – **POWAFLEX**
- Water Management System – **SiL**
- Wearing Compounds – **LOCTITE, DEVCON**



SEALING OPTIONS

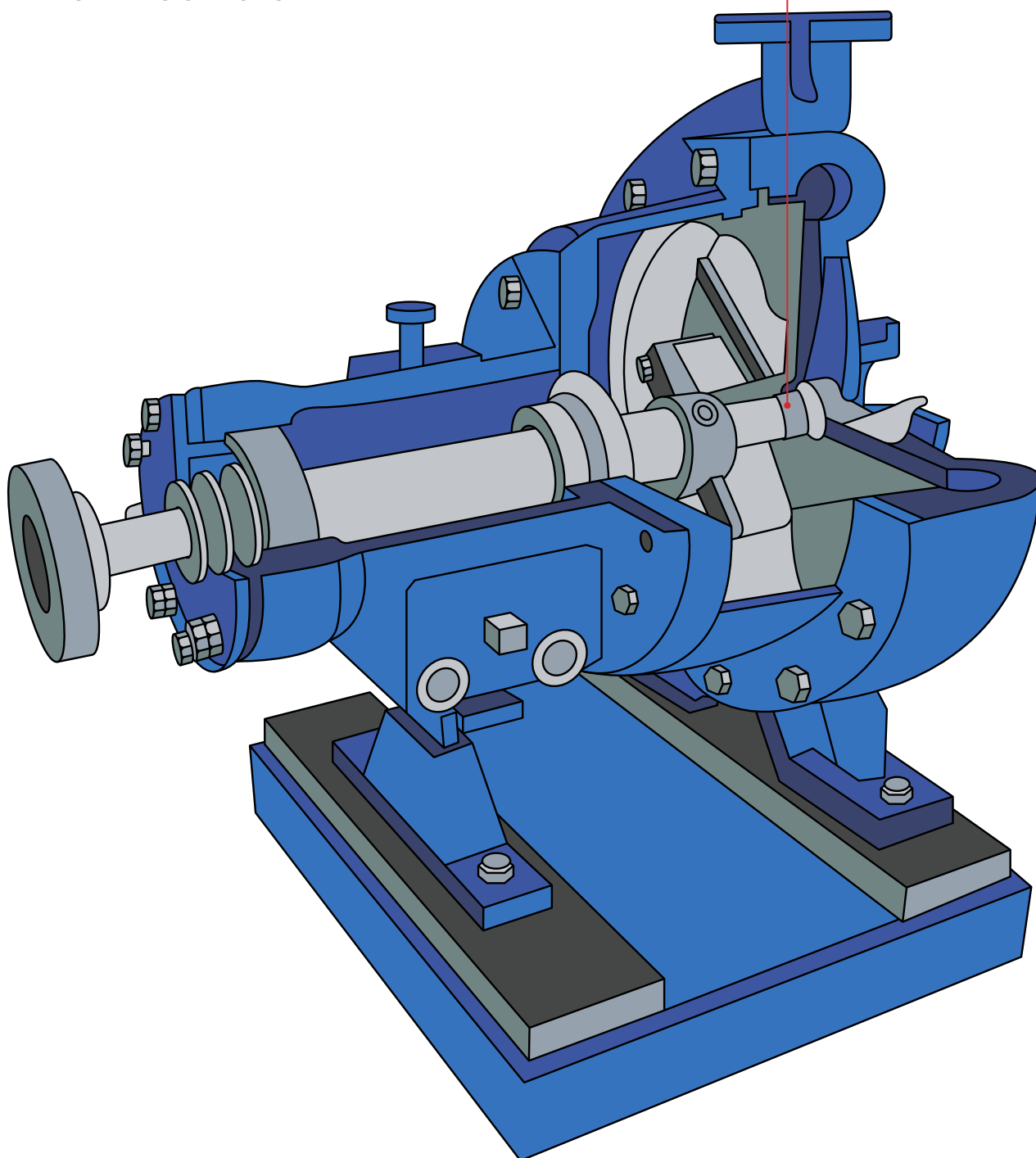

EXPPELLER SEAL

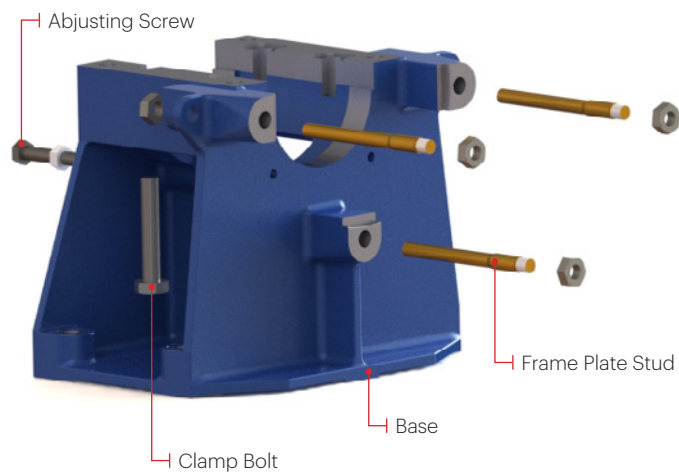
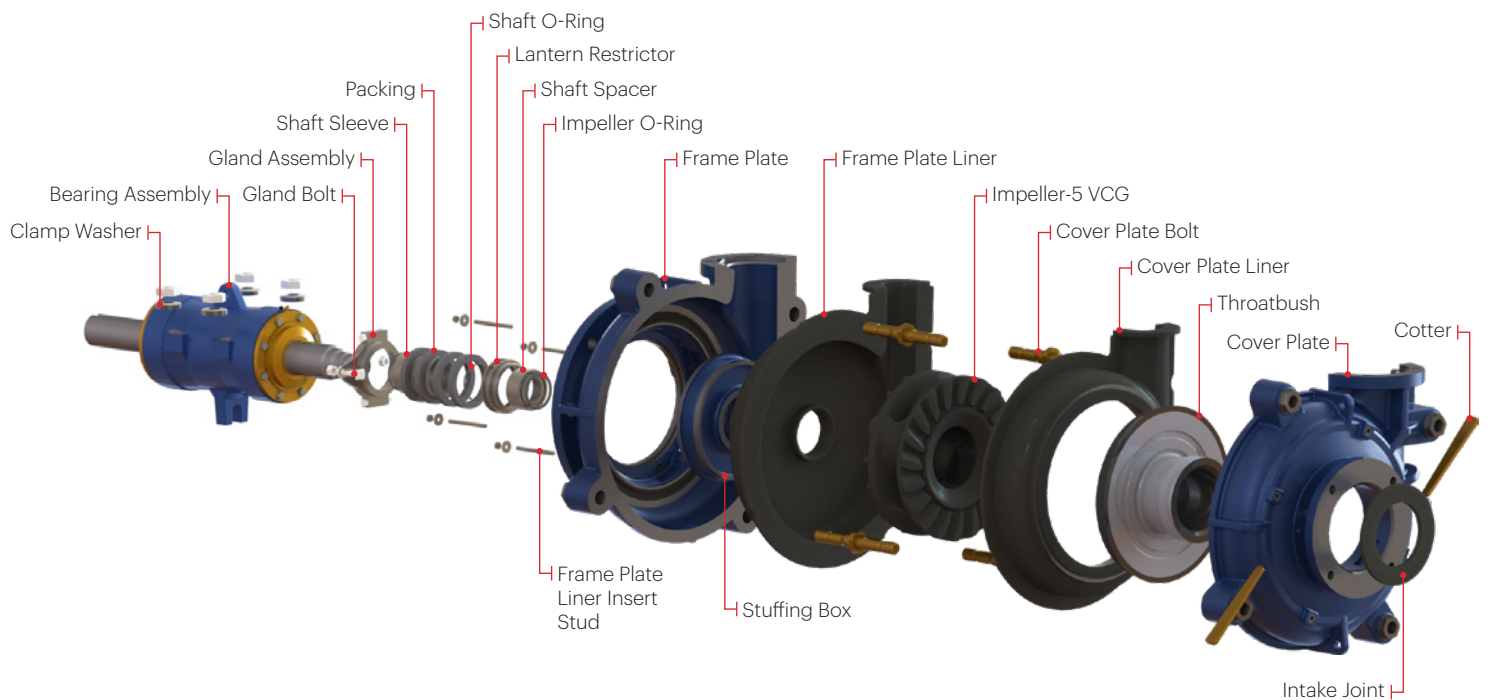
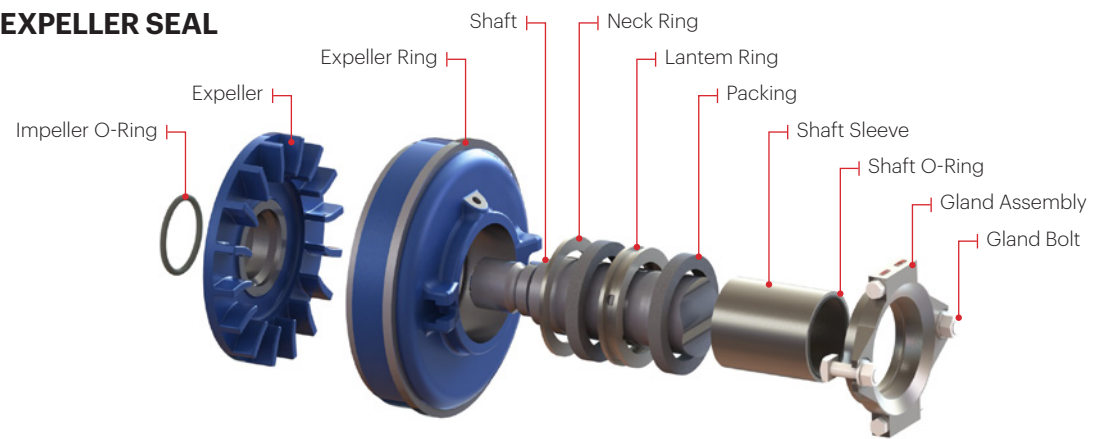

PROBLEM SOLVERS



Corrosion Protection Tape

3M™ Scotchrap™ Tape 51 is a premium grade, 20 mil thick, all weather tape with PVC backing. It withstands temperatures of -55 to 176 °F (-48 to 80 °C) and resists abrasion and punctures. It is corrosion and impact resistant, making it suitable for use on metal piping systems, conduits and fittings both above and below ground.

Leading Questions

- Are you currently using Denzo tape on your exposed threads?



Extractor and Tamping Tools

Highly efficient and widely used extraction tool, with long flexible shank to gain access to glands in difficult positions. A T-handle provides good grip for both screw action and the efficient removal of packings.

Leading Questions

- Are your staff currently using any tools to extract or install pump packings on the site?



LOCTITE® PC 7227

LOCTITE® PC 7227 is a 2-part, grey, flowable, ultra-smooth, ceramic-reinforced epoxy kit providing a high gloss, low friction coating. Typically used to provide a smooth, protective abrasion resistant coating and for repairing heat exchangers and condensers, lining tanks and chutes, resurfacing and repairing rudders and pintel housings and repairing cooling pump impellers and butterfly valves.

Leading Questions

- Do you currently use any epoxies on the wearing components of your pumps?



Gates Maintenance Kit

Optimum belt drive performance is not achieved via guess work, you need the right tools for the job. Gates Maintenance Tool Kit (GIBMAINT-3) allows any belt drive to be accurately installed and maintained.

Leading Questions

- How do the maintenance staff currently check v-belt tension?



Single Point Lubricator

The BEKAONE is especially designed for situations where an automatic lubrication system is too large or too complex. BEKAONE single point lubricators are an ideal solution to supply lubricants to individual greasing points in a safe, precise and reliable way.

Leading Questions

- Are you only using manual greasing methods?



LOCTITE® 518

LOCTITE® 518 cures when confined in the absence of air between close-fitting metal surfaces. It is an anaerobic gasketing material designed for use on rigid iron, aluminium, and steel flanged mating surfaces. LOCTITE 518 fills gaps up to 0.25mm and forms a flexible, chemical-resistant seal that will not tear or decay.

Leading Questions

- Are you using paper gaskets on your pump flanges?



TECO Variable Speed Drives

Designed to comply with worldwide standards and power ratings to deliver a cost-effective solution for various application requirements. E510s can support PM Motor Control, Safety Torque Off, Built-in PLC, Internal Communication Module, IP66 Enclosure, which makes it even more suitable for standalone machine level control applications or simple system integration.

Leading Questions

- Are you running any variable speed drives on the site?



Falk Motor Coupling Guard

Falk Motor Coupling Guard (MCG) for use with NEMA Motor Frames from 284T to 326TS or IEC Motor Frames from 180M to 280M, Size 25, ANSI Safety Orange.

Leading Questions

- Are you making your own coupling guards?

Service & Engineering

- All pump spares
- Condition monitoring
- Cost savings
- Energy audits
- Engineering walkthroughs
- Full pump repair service
- Industry 4.0 technology – ABB SmartCheck
- Laser alignments
- Mechanical seal repairs and refurbishment
- Oil analysis
- On site evaluation of seals, machinery & pumps
- On site monitoring
- Pump base fabrication
- Refurbishment
- Reliability improvement
- Repairs
- Rotating equipment repair
- Servicing
- Site audits
- Site surveys
- Steam turbine repairs
- Supply and repair to all makes of pumps
- Thermal imaging and mapping – design, development and consultancy
- Training
- Troubleshooting
- V-Belt Tensioning



Anytime. Anywhere. **Always Here.™**

MOTION AUSTRALIA is the leading supplier of original and replacement parts for Australian industry as well as a premier provider of engineered solutions to increase customer's productivity and uptime. With the goal of delivering a best in class customer experience, Motion **offers many valued-added services, including engineering, design and fabrication along with workshop and on-site services.**

PRODUCTS – Bearings, Power Transmission & Drives, Hydraulic & Industrial Hose, Fluid Power, Industrial Supplies, Fasteners, Sealing products, Process Pumps, **and MORE!**



MOTION
Australia

1300 211 954
MotionAus.com